

MINI AIR EASI 2

air cushion system

User Manual

Specification

Power: AC110V-220V; 50Hz-60Hz

Power Consumption:120W

Speed: 8m/min

Weight: 4kgs

Color: Gray

Size: 405mm x 220mm x195mm

Accessories

Parts listed below included:



Allen Keys



Teflon sticker



Power cord

Operation

A. Plug in power cord on the machine then switch machine power on "I"

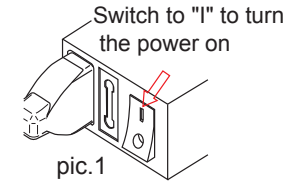

B. After step A, screen on the control panel will show the machine serial number



EAB: serial number

pic.2

C. After 5 seconds, the screen will enter into the operation panel.



TMP: Temperature
FAN: Air volume

pic.3

D. Unlock the Knob

- Turn it as "On" position before use the machine.
- Recommend to turn the knob off when not use to extend the parts lifetime.

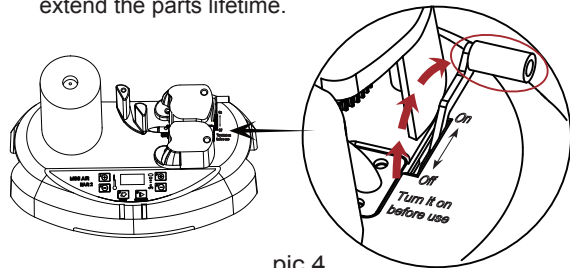
**E. Load film roll**

- Put the roll onto film roll holder.
(Film roll edge with air channel sides down)
- Slide the film roll following the path shown below. Open the air channel and slide the air channel over the end of the air nozzle.
- Slide the film roll until it reach the red roller, then press(Hold) the "in/out" until the film get through

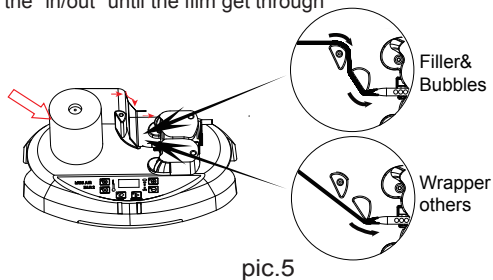

Filler & Bubbles

Wrapper others

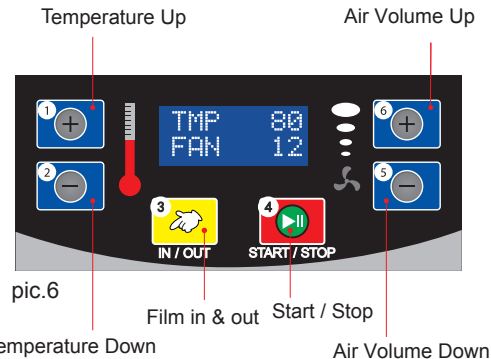
Settings

Film in & out

Start / Stop

Air volume referenceRecommended Air volume
(For HDPE 20µm)

Wrapper	Fan
Bubbles	38
Tube large	30
Tube small	35
Tube multi	38
Filler	Fan
200x100mm(8"x4")	17
200x130mm(8"x5")	16
200x150mm(8"x6")	16
200x200mm(8"x8")	16



Operation / Maintenance



User Manual

Better Cushion
Better Protection

www.amesonpak.com

Version 2019